

لجنة أبوظبي للأفلام  
Abu Dhabi Film Commission

# ABU DHABI LOCATIONS GUIDE

STARTING AT

**\*35%++**

**CASHBACK**

REBATE ON YOUR  
PRODUCTION SPEND

\*T&Cs apply

## ABOUT ABU DHABI

Abu Dhabi, the capital of the United Arab Emirates is a vibrant metropolis bustling with trade and tourism.

It is a place known for the friendliness and hospitality of its people and was named safest city in the world by Global statistic database, Numbeo, in its 2022 survey.

Located at the crossroads of the region, Abu Dhabi is a melting pot of cultures. This unique geographic location, along with a highly developed aviation sector and state-of-the-art infrastructure, makes Abu Dhabi a highly accessible destination for the global film industry.

## ABOUT ABU DHABI FILM COMMISSION

Abu Dhabi Film Commission (ADFC), which operates under the umbrella of the Creative Media Authority, offers a rebate starting at \*35%++ rebate on all qualifying film and TV production spend in the Emirate of Abu Dhabi.

It was established in 2009 with a mandate to support the development of Abu Dhabi's rapidly growing film & television industry, and to promote the Emirate as a location for production and filming.

ADFC's support services include assistance with filming permits and visa's, script clearance advice, initial scouting for locations, plus access to companies within the UAE that provide production services, equipment and crew.

Our services:

- Cashback rebate starting at \*35%++ on film and TV production spend.
- Scouting assistance on a diverse range of unique locations including stunning coastline, wild desert, amazing oasis and iconic architecture.
- Support with location film and talent sourcing
- Advice and assistance with government requests, permits, visas, script approval, importing equipment and filming permits.

**\*T&Cs apply**

## LOCATIONS IN ABU DHABI

Abu Dhabi is unmatched in the diversity of its natural and constructed filming locations. The city, and the extended Emirate, blend desert and coastal landscapes, mangroves, and beaches with distinct urban settings, featuring Arabian-style landmarks, luxurious hotels, modern high-rise buildings and neighbourhoods, and architectural marvels.

And if your production requires a special setting or period features, look no further than the twofour54's 300,000m<sup>2</sup> backlot, where you can utilize unique infrastructure and preconstructed sets to make your production as unique as possible.



*Abu Dhabi Film Commission Locations Reel*



\*T&Cs apply

## CENTRAL LOCATION TO THE WORLD

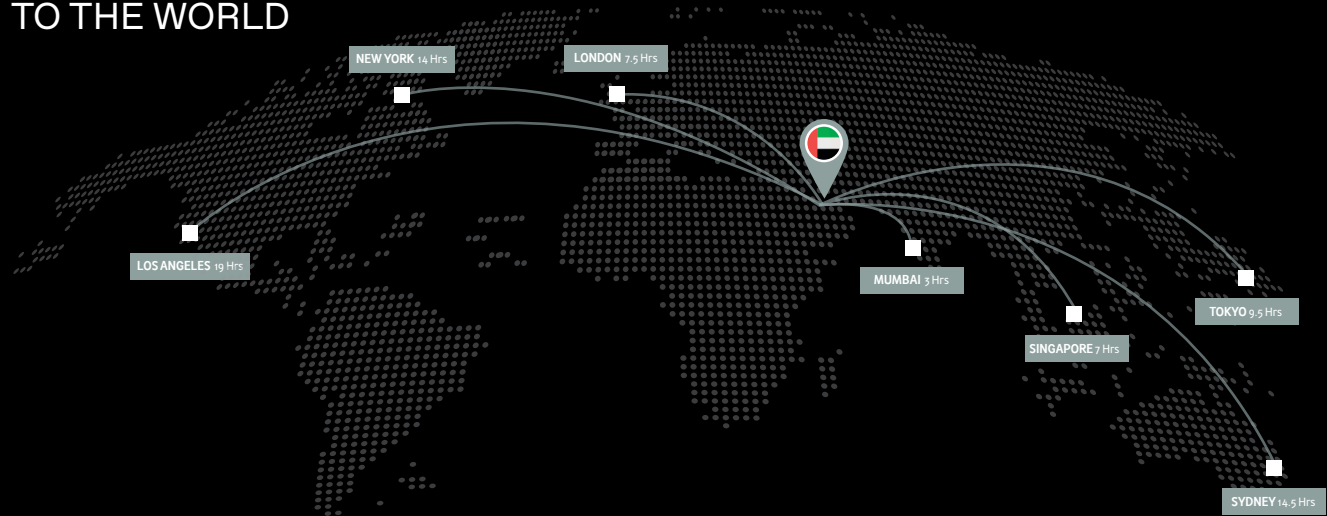

## General facts about Abu Dhabi

Abu Dhabi	Capital of the United Arab Emirates
Official Languages	Arabic & English
Total Area	67,340 sq. km
Climate	Tropical, semi-dry climate with hot summers and warm winters
Currency	UAE Dirham (AED) / 1 USD = 3.68 AED

Population	3.8 million.
GDP	USD 310 billion

\*T8Cs apply

لجنة أبوظبي للأفلام  
Abu Dhabi Film Commission

# A WORLD OF LOCATIONS



\*T8Cs apply

# 01 MODERN ARCHITECTURE



\*T&Cs apply

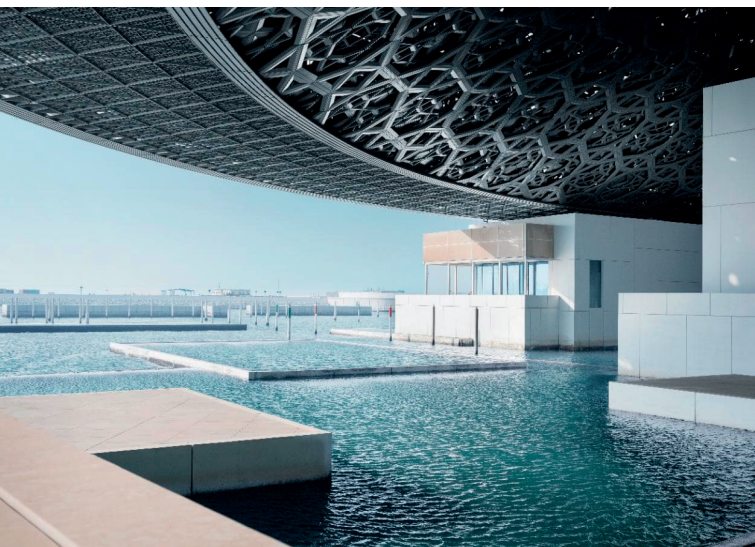

\*T8Cs apply

LOUVRE ABU DHABI

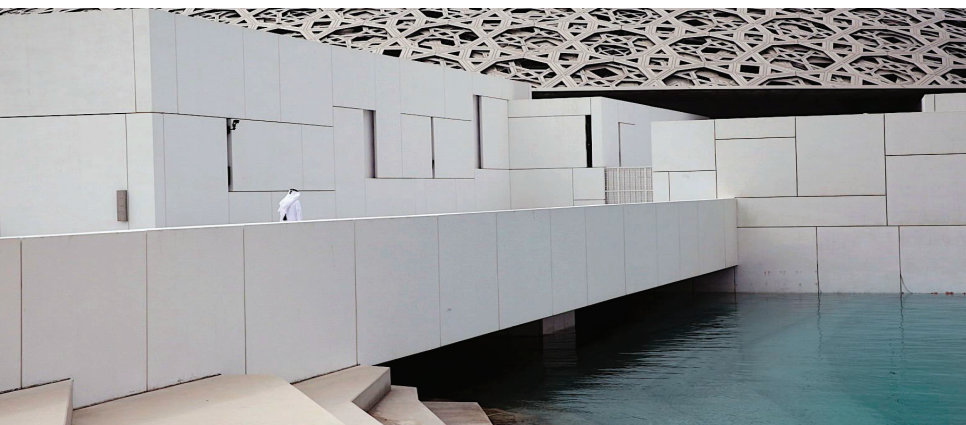

ETIHAD ARENA

ETIHAD ARENA

A NEW LANDMARK  
OF ENTERTAINMENT

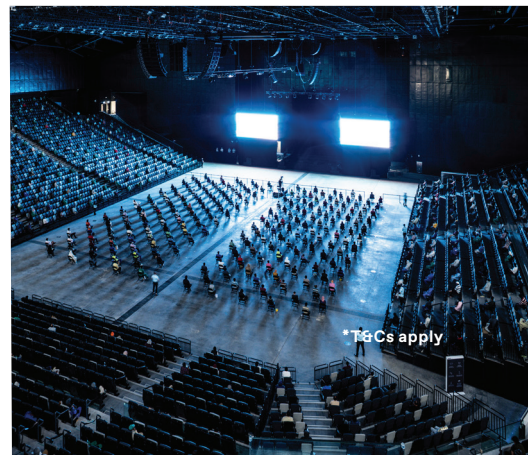





ABU DHABI NATIONAL  
EXHIBITION CENTER



\*T&Cs apply

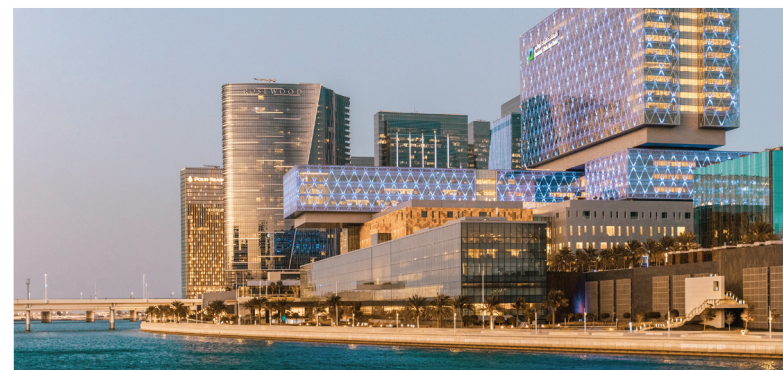

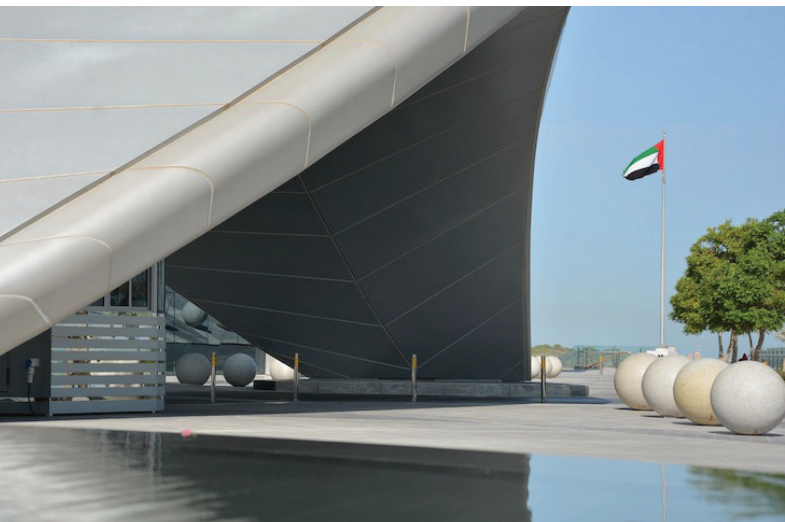



CLYMB ABU DHABI

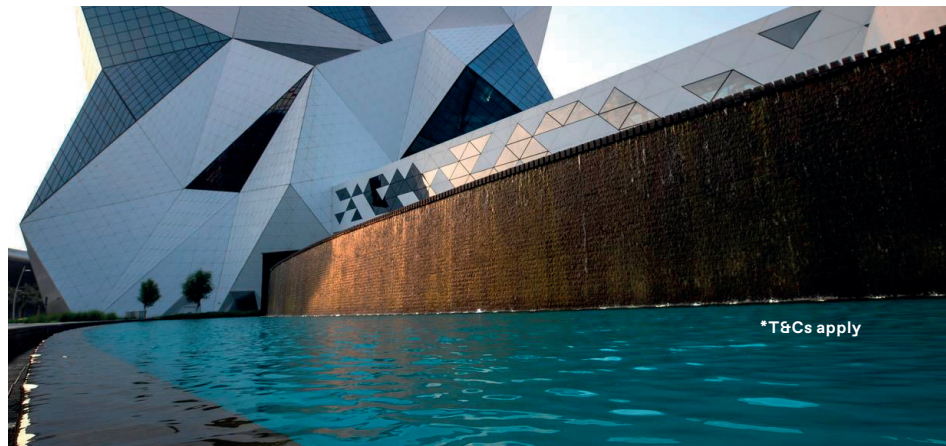

\*T8Cs apply

AL QANA

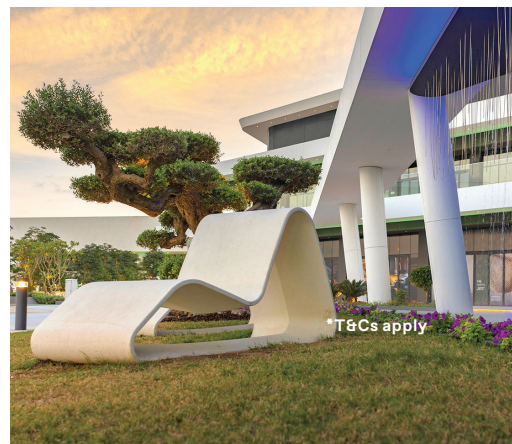



CAPITAL GATE



\*T8Cs apply





MASDAR CITY

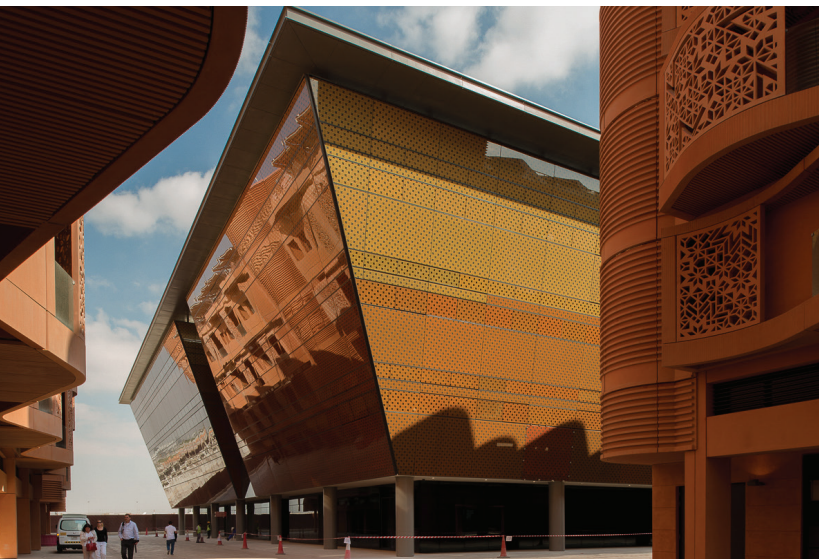

T8C6 apply



## 02 CITY



ABU DHABI CITY





\*T8Cs apply

ABU DHABI CITY





## 03 BRIDGES



SHEIKH KHALIFA BRIDGE



SHEIKH ZAYED BRIDGE





MAQTA BRIDGE



HUDAYRIAT BRIDGE

\*T8Cs apply

## 04 COAST







\*T8Cs apply

NURAI ISLAND

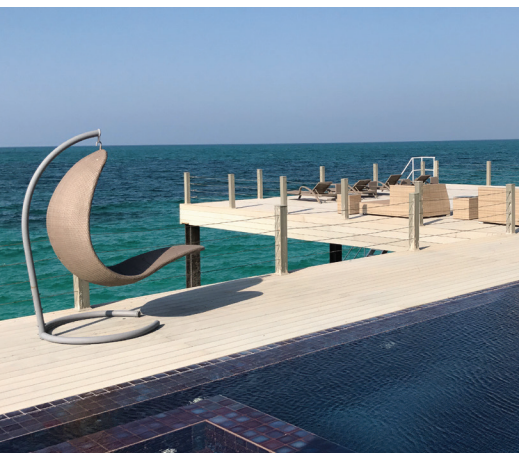



SAADIYAT BEACH CLUB



\*T&Cs apply

YAS BEACH





KAI BEACH ABU DHABI

\*T&Cs apply

## 05 ARABIAN



\*T&Gs apply

EMIRATES PALACE

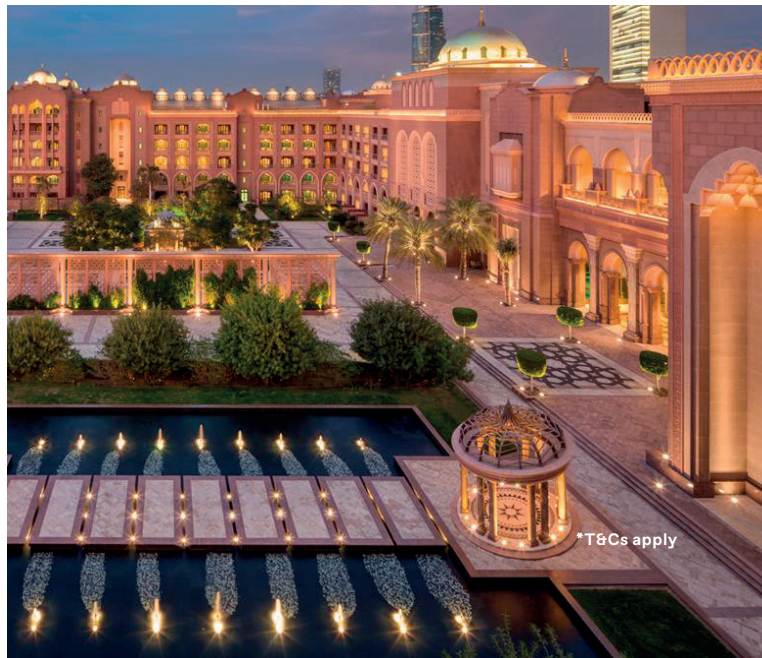

## ARABIAN NIGHTS VILLAGE



QASR AL SARAB





\*T&Cs apply

An aerial photograph of the Telal Resort, a large tented camp in a desert. The resort features a central swimming pool with palm trees and lounge chairs, surrounded by numerous white tents. The camp is nestled among green trees and shrubs, with sand dunes in the background. A winding road and parking area are visible to the left.

TELAL RESORT

\*T&Cs apply



\*T&Cs apply

THE WESTIN



\*T&Cs apply



## 06 AMUSEMENT & THEME PARKS



FERRARI WORLD



WARNER BROTHERS ABU DHABI



SEA WORLD ABU DHABI





SNOW ABU DHABI



\*T8Cs apply

## 07 HISTORICAL ARCHITECTURE





AL JAHILI FORT





AL ANKAH FORT



SHEIKH ZAYED HERITAGE CENTRE

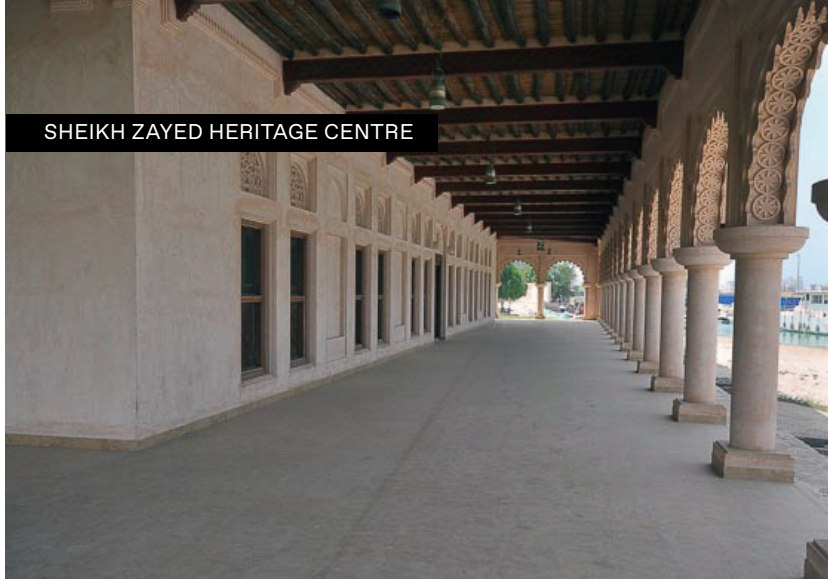

MEZYAD FORT



SAMALIYAH ISLAND



## 08 GENERIC MIDDLE EASTERN





MINA SOUK



WORLD TRADE CENTER SOUK

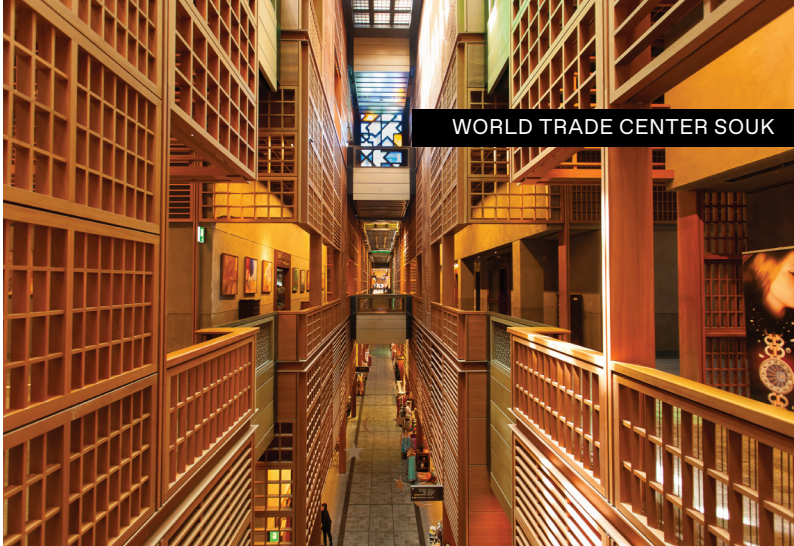

WORLD TRADE CENTER SOUK



MINA DATE SOUK







## 09 DESERT

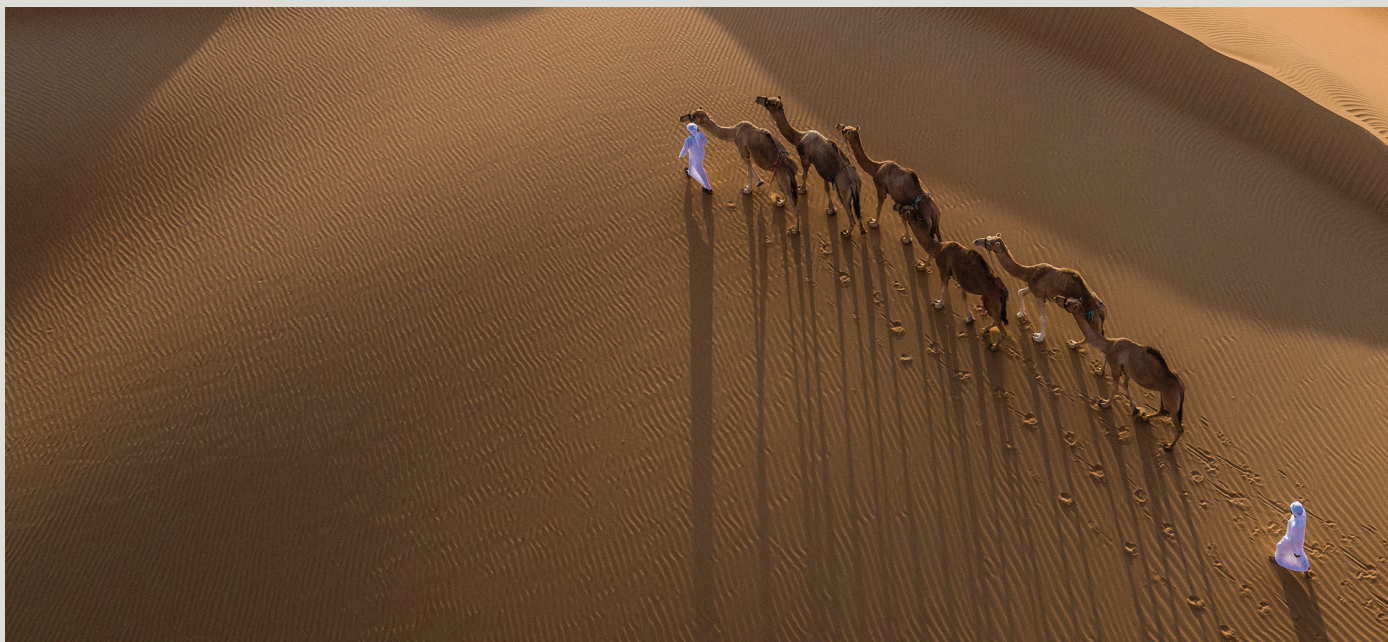







## 10 NATURE





AL AIN OASIS







# 11 MOUNTAINS



JEBEL HAFEET MOUNTAINS





HAFEET MOUNTAIN







## 12 BACKLOT & STUDIOS



TWOFOUR54 BACKLOT





مستشفى مدينة الكريت  
CITY HOSPITAL IKRIT

الطوارئ  
EMERGENCY

WING-B

C-2007-10

TWOFOUR54 BACKLOT



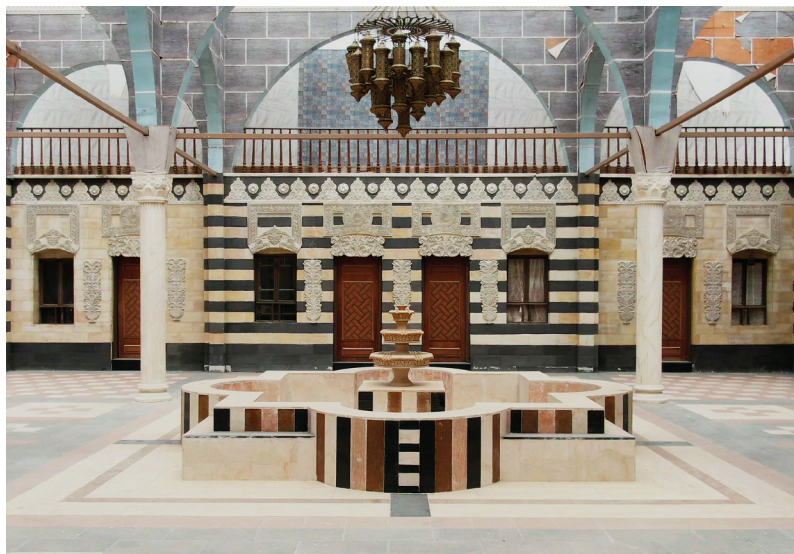

TWOFOUR54 SOUND STAGE





CANTEEN



DRESSING ROOM



MEETING ROOM

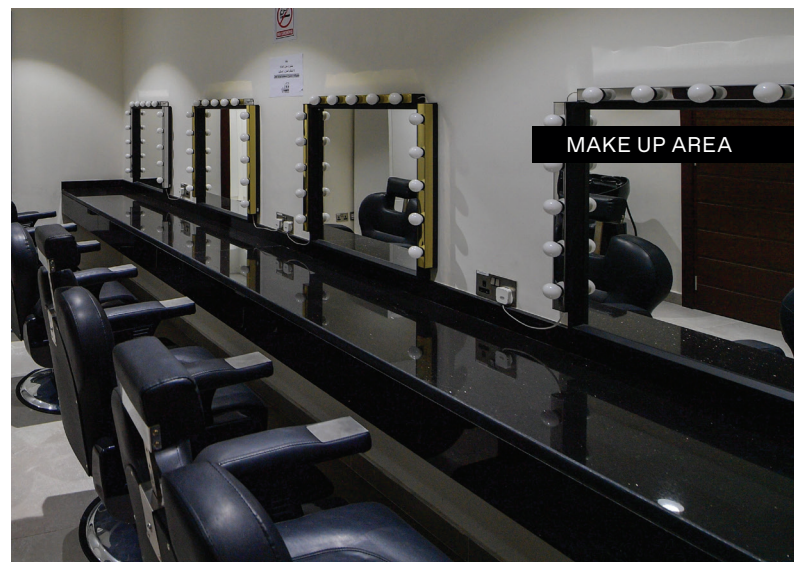

MAKE UP AREA

